

MODEL 9-250 MINI TUBE / FITTING WELD HEAD



*Model 9-250
Shown with Standard Clamp Plates*

- Extremely small profile. Thin enough for fitting to fitting applications and small enough to fit component clusters, such as a mini tee to a gland with a female nut.
- Removable clamp plates adapt the head to various tube/fitting sizes.
- Compatible with all Arc Machines, Inc. power supplies.

MINI TUBE / FITTING WELD HEAD

The Arc Machines Model 9-250 is a precision, orbital GTAW (TIG) welding head designed for fusion butt welding of tubing, fittings, valve bodies and other components with extreme clearance limitations. Semiconductor gas cabinets, aerospace components and instrumentation are just a few of the applications that this head is suited to.

Tooling for this weld head is comprised of matched sets of hardened clamp plates. These clamps open with a scissor action, and grip onto the tube or fitting with an integral clevis latch. This precision tooling holds the parts square and concentric, and requires no tools for operation. A sight window provides the operator with the ability to check fit-up prior to welding.

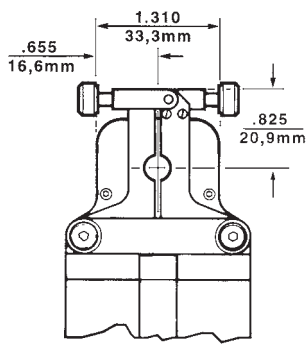

Front View

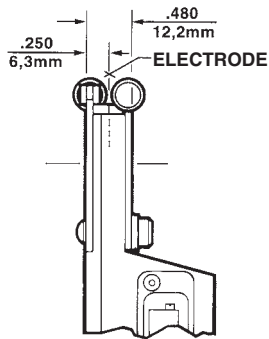

Side View

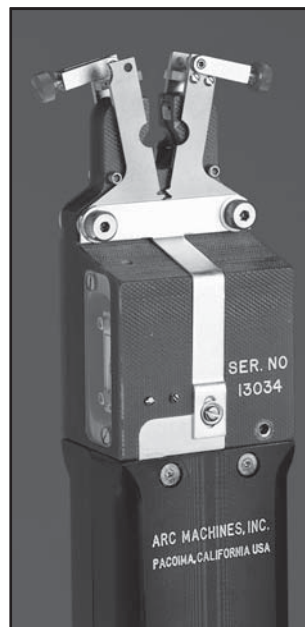

Clamp plates are interchangeable to accommodate tube/fitting sizes up to 1/4" (6.35mm).

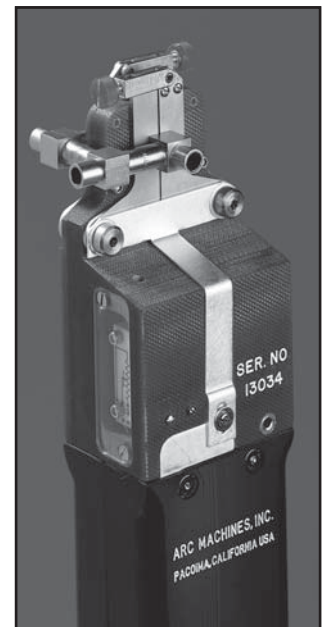

Extremely tight radial and axial clearance requirements facilitate the welding of component clusters. Four mini tees show welded together.

Tube / Fitting Capacity

Tube O.D.: 3/32" to 1/4"
2.3mm - 6.35mm

Mini-Fittings: 1/8" and 1/4"
4 and 6mm

Technical Data

Process: GTAW (TIG) Autogenous
Travel Motor: Tachometer feedback, D.C.
Head Weight: 1.75 lbs. (800 g)

Electrode Size: 0.040" (1.0mm)
Electrode RPM: 0.1 to 20.0
Cable Length: 20 ft. (6m)
Extensions available

ARC MACHINES, INC.